

Werkstatt für Neues

2024 02 20



The room Werkstatt für Neues is located in the rear building of the Baronessvilla and is 75 sqm big. It features three outdoor working areas and an atmosphere out of the ordinary. The arrangement of the seating is open.

Category	Floor space	Ceiling height	Length/Width
M	75 sqm	3.0m	8.7 m x 8.6 m

Capacity

Open seating arrangement
Seats 12

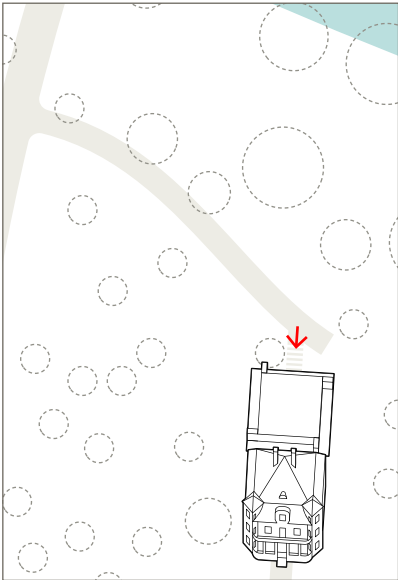

Equipment

Video/Audio

- High-performance projector 4K Ultra HD 2.900 ANSI lumens with VGA and HDMI port and screen

Internet

- WLAN

Facilitation

- Innovative presentation material
- Extraordinary working material
- 3 Metaplan boards

And...

- Dial extension -934 for immediate support

Stuckzimmer



2024 02 20



The room Stuckzimmer is located on the first floor of the castle and is 71 sqm big, split into 43 and 28 sqm. The seating arrangement is permanent.

Category	Floor space	Ceiling height	Length/Width
M	43sqm+28sqm	3.2 m	7.4m×5.7/3.7m

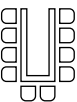
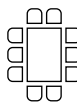
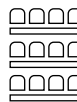
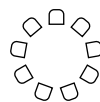
Capacity

				
U-shape	Boardroom style	Classroom style	Round table	Theatre style
-	14	-	-	-

Equipment

Video/Audio

- cannyboard video conferencing and collaboration tool with 86" sessionboard (219 cm diagonal, multitouch 4K display), HDMI port
- Barco ClickShare

Internet

- WLAN/LAN

Facilitation

- 1 large presentation kit
- 1 quality flipchart with wheels
- 2 quality pinboards with wheels

And...

- Dial extension -934 for immediate support

As well as notepad and pen at the desk for each participant

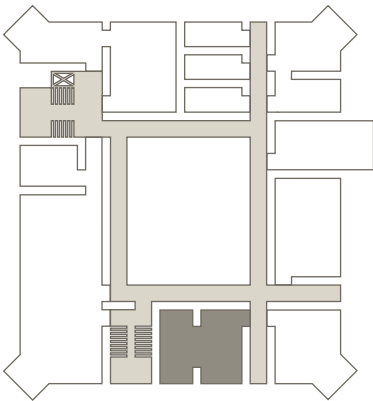

Kaminzimmer



2024 02 20



The room Kaminzimmer is located on the ground floor of the Gutshof and is 68 sqm big. The arrangement of the seating is flexible. The room is equipped with a terrace (garden furniture is provided during the summertime).

Category	Floor space	Ceiling height	Length/Width
M	68 sqm	3.4 m	13.4 m x 5.1 m

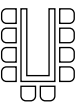
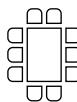
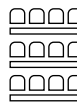
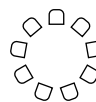
Capacity

				
U-shape	Boardroom style	Classroom style	Round table	Theatre style
18	18	20	14	32

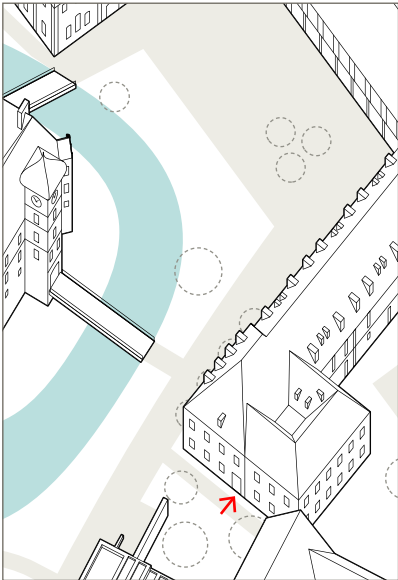

Equipment

Video/Audio

- cannyboard video conferencing and collaboration tool with 86" sessionboard (219 cm diagonal, multitouch 4K display), HDMI port
- Barco ClickShare

Internet

- WLAN/LAN

Facilitation

- 1 large presentation kit
- 1 quality flipchart with wheels
- 2 quality pinboards with wheels

And...

- Dial extension -934 for immediate support

As well as notepad and pen at the desk for each participant

Kleines Gewölbe

2024 02 20



The room Kleines Gewölbe is located on the first floor of the castle and is 65 sqm big. It features an atmosphere out of the ordinary. The arrangement of the seating is open.

Category	Floor space	Ceiling height	Length/Width
M	65 sqm	2.8 m	9.8 m x 8.4 m

Capacity	Recommended for
Open seating arrangement Seats 12	Fireside evening for informal exchange and open mingling as well as coaching, job interviews, target talks, etc.

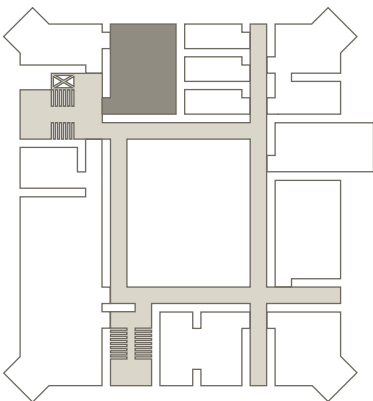

- Equipment**
- Internet**
 - WLAN/LAN
 - And...**
 - Notepad and pen at the desk for each participant

Scagliolazimmer



2024 02 20



The room Scagliolazimmer is located on the first floor of the castle and is 48sqm big. It features an oriel, about 2.5 m x 2.5 m big. The arrangement of the seating is flexible.

Category	Floor space	Ceiling height	Length/Width
M	48sqm	3.2m	7.4m x 6.5m

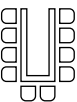
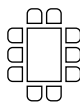
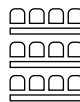
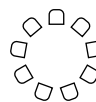
Capacity

				
U-shape	Boardroom style	Classroom style	Round table	Theatre style
14	15	18	18	30

Equipment

Video/Audio

- cannyboard video conferencing and collaboration tool with 86" sessionboard (219 cm diagonal, multitouch 4K display), HDMI port
- Barco Click Share

Internet

- WLAN/LAN

Facilitation

- 1 large presentation kit
- 1 quality flipchart with wheels
- 2 quality pinboards with wheels

And...

- Dial extension -934 for immediate support

As well as notepad and pen at the desk for each participant

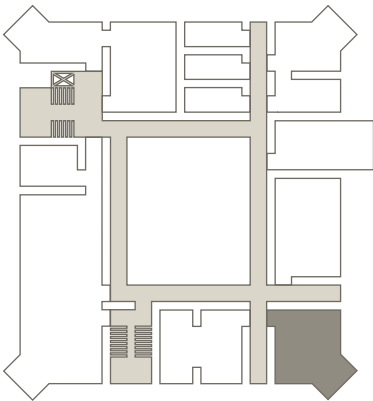

Glonnblick

2024 02 20



The room Glonnblick is located on the ground floor of the Altes Försterhaus and is 48sqm big. It features an atmosphere out of the ordinary. The arrangement of the seating is open.

Category	Floor space	Ceiling height	Length/Width
M	48sqm	2.9m	7.2m x 6.6m

Capacity

Open seating arrangement
Seats 12

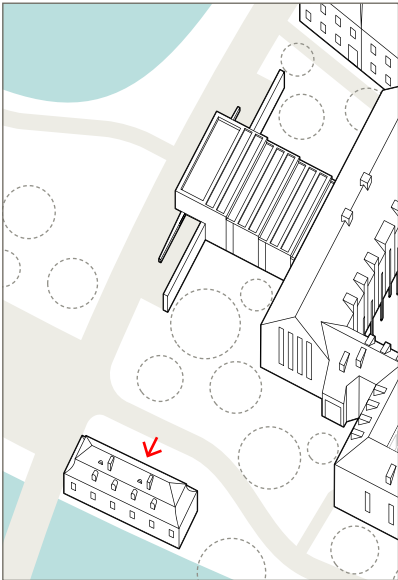

Equipment

- Video/Audio**
- Flat screen, 65" television
 - Barco ClickShare

Internet

- WLAN

Facilitation

- 1 large presentation kit
- 1 quality flipchart with wheels
- 2 quality pinboards with wheels
- 1 quality black pad firmly attached

And...

- Dial extension -934 for immediate support



As well as notepad and pen at the desk for each participant



The room Klausur 2 is located on the ground floor of the castle and is 42 sqm big. It features an oriel, about 2.5 m x 2.5 m big. The arrangement of the seating is flexible.

Category	Floor space	Ceiling height	Length/Width
M	42 sqm	2.6 m	6.9 m x 6.1 m

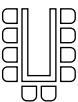
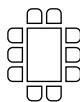
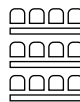
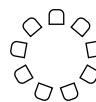
Capacity

				
U-shape	Boardroom style	Classroom style	Round table	Theatre style
10	12	11	14	16

Equipment

Video/Audio

- cannyboard video conferencing and collaboration tool with 86" sessionboard (219 cm diagonal, multitouch 4K display), HDMI port
- Barco ClickShare

Internet

- WLAN/LAN

Facilitation

- 1 large presentation kit
- 1 quality flipchart with wheels
- 2 quality pinboards with wheels

And...

- Dial extension -934 for immediate support

As well as notepad and pen at the desk for each participant

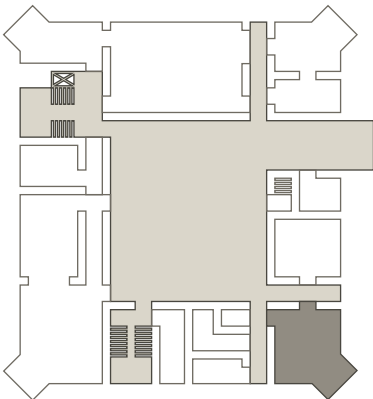





The room Klausur 1 is located on the ground floor of the castle and is 42 sqm big. The arrangement of the seating is flexible.

Category	Floor space	Ceiling height	Length/Width
M	42 sqm	2.6m	7.0m x 6.2m

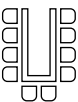
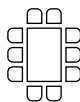
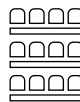
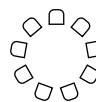
Capacity

				
U-shape	Boardroom style	Classroom style	Round table	Theatre style
10	12	11	14	16

Equipment

Video/Audio

- cannyboard video conferencing and collaboration tool with 86" sessionboard (219 cm diagonal, multitouch 4K display), HDMI port
- Barco ClickShare

Internet

- WLAN/LAN

Facilitation

- 1 large presentation kit
- 1 quality flipchart with wheels
- 2 quality pinboards with wheels

And...

- Dial extension -934 for immediate support

As well as notepad and pen at the desk for each participant

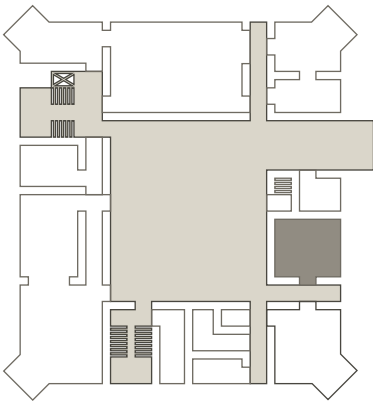

Turm der Ideen

2024 02 20

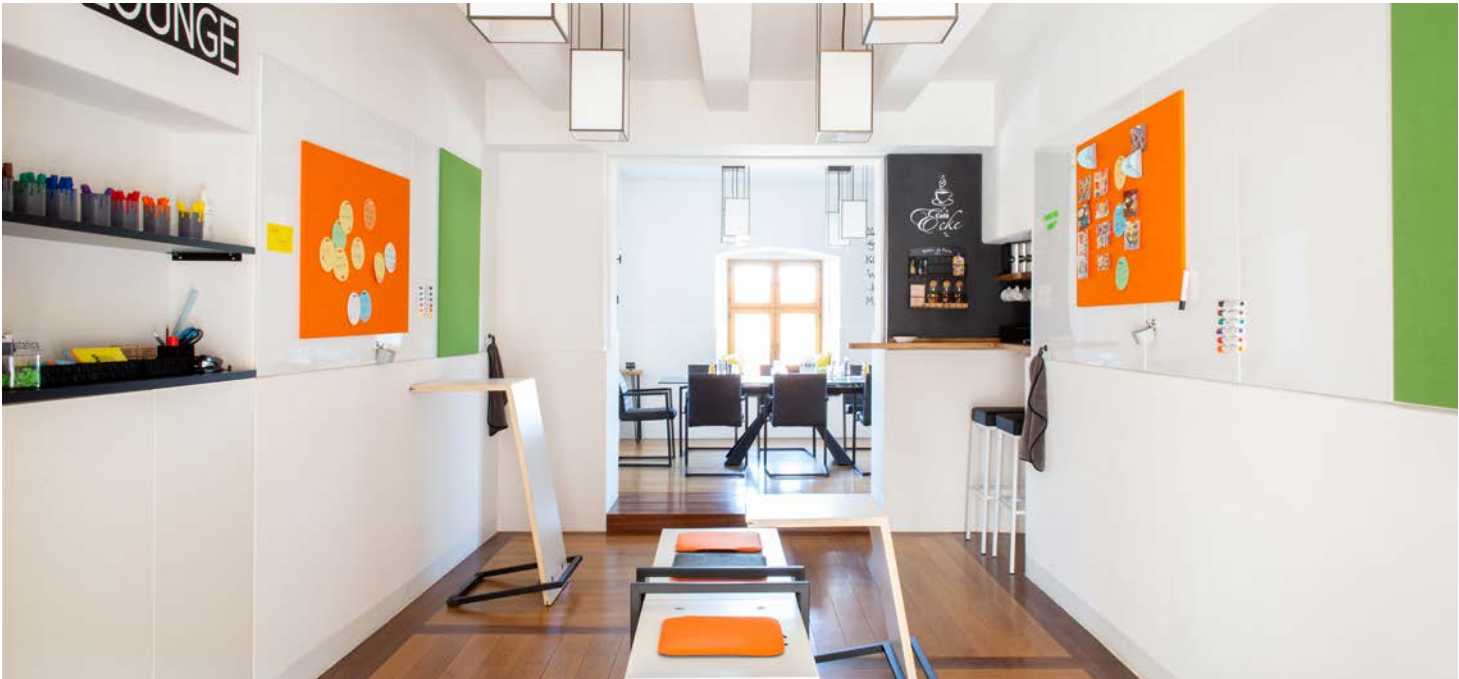

The room Turm der Ideen is located on the second floor of the castle and is 42 sqm big, which includes a 16 sqm big oriel. It features two working areas and an atmosphere out of the ordinary.

Category	Floor space	Ceiling height	Length/Width
M	42 sqm	2.8 m	6.7/4.6m x 3.5m

Capacity

Two working areas with permanent and open seating arrangement
Seats 8

Equipment

Video/Audio

- Samsung Flip

Internet

- WLAN/LAN

Facilitation

- High-quality working materials
- Writable magnetic walls
- Coloured repositionable magnetic pin boards

As well as notepad and pen at the desk for each participant

And...

- Dial extension -934 for immediate support

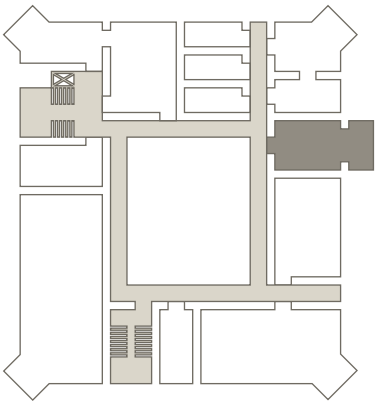





The room Wappenzimmer is located on the second floor of the castle and is 41 sqm big. It features an oriel, about 2.5 m x 2.5 m big. The seating arrangement is permanent.

Category	Floor space	Ceiling height	Length/Width
M	41 sqm	2.8 m	8.3 m x 4.8 m

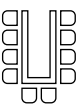
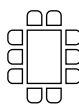
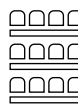
Capacity

				
U-shape	Boardroom style	Classroom style	Round table	Theatre style
-	14	-	-	-

Equipment

Video/Audio

- cannyboard video conferencing and collaboration tool with 86" sessionboard (219 cm diagonal, multitouch 4K display), HDMI port
- Barco ClickShare

Internet

- WLAN/LAN

Facilitation

- 1 large presentation kit
- 1 quality flipchart with wheels
- 2 quality pinboards with wheels

And...

- Dial extension -934 for immediate support

As well as notepad and pen at the desk for each participant

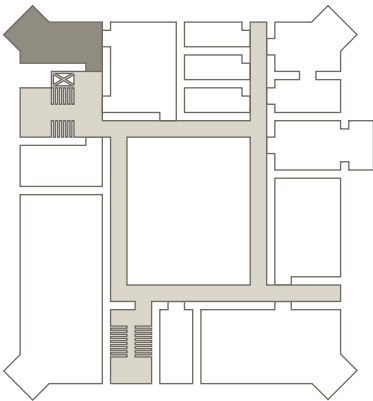





The room Klausur 3 is located on the first floor of the castle and is 38sqm big. It features an oriel, about 2.5 m x 2.5 m big. The seating arrangement is permanent.

Category	Floor space	Ceiling height	Length/Width
M	38sqm	3.2m	8.2 m x 4.6 m

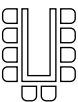
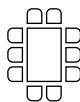
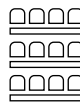
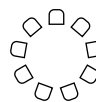
Capacity

				
U-shape	Boardroom style	Classroom style	Round table	Theatre style
-	14	-	-	-

Equipment

Video/Audio

- cannyboard video conferencing and collaboration tool with 86" sessionboard (219 cm diagonal, multitouch 4K display), HDMI port
- Barco ClickShare

Internet

- WLAN/LAN

Facilitation

- 1 large presentation kit
- 1 quality flipchart with wheels
- 2 quality pinboards with wheels

And...

- Dial extension -934 for immediate support

As well as notepad and pen at the desk for each participant

